



SPRAY CHARACTERISTICS

- Precision, low capacity nozzle with uniform distribution in a solid cone shaped pattern.
- Uniform distribution of finely atomised droplets.

CONSTRUCTION AND MATERIALS

- Used with standard bodies and caps.
- Core is multi-slotted for uniform distribution.
- Body thread sizes are Male BSPT and Female BSPP.
- Standard spray angles are 45°, 60° and 90°.
- Other angles available to special order.
- Threaded strainer is optional (see chart for mesh size).
- Available in Brass or Stainless Steel as standard.
- Other materials available on a special order.

ORDER EXAMPLE

WL 6-45° Brass = Tip Only.

1/4" WLM (Male) 12-60° Stainless Steel = Complete Assembly.

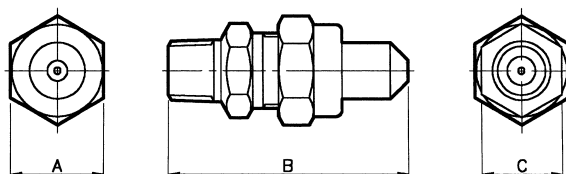

WLM (MALE) ASSEMBLY

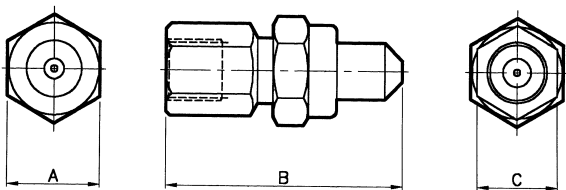

WLF (FEMALE) ASSEMBLY

DIMENSIONS AND WEIGHTS

Assembly Type	Dimensions (mm)			Weight (g)
	A Hex	B	C Hex	
1/8" WLF	20,8	54,0	18,0	70
1/8" WLM	20,8	52,4	18,0	60
1/4" WLF	20,8	54,0	18,0	70
1/4" WLM	20,8	54,0	18,0	62
3/8" WLF	20,8	54,0	20,8	70
3/8" WLM	20,8	54,0	18,0	64

Maximum Recommended
Pressure: 35 Bar.G.

CAPACITY CHART

NOZZLE NUMBER	MESH SIZE	FLOW RATE IN LITRES/HOUR AT Bar.G.							
		0,7	1	1,5	2	3	4	6	7
3	200	7,4	8,7	10,4	11,9	14,2	16,2	18,9	20,7
4	200	9,9	11,6	13,9	16,0	19,0	21,7	25,3	27,7
5	200	12,3	14,4	17,3	19,9	23,7	27,0	31,5	34,6
6	100	14,8	17,3	20,7	23,9	28,4	32,4	37,8	41,5
7	100	17,3	20,3	24,2	27,9	33,2	37,8	44,2	48,5
8	100	19,7	23,1	27,7	31,8	37,9	43,2	50,4	55,3
9	100	22,2	26,0	31,2	35,9	42,7	48,7	56,8	62,3
10	100	24,6	28,9	34,6	39,8	47,4	54,0	63,0	69,2
12	100	29,6	34,7	41,5	47,8	56,9	64,9	75,7	83,1
14	100	34,5	40,5	48,5	55,8	66,4	75,7	88,3	97,0
16	50	39,5	46,3	55,4	63,8	75,9	86,5	101,0	111,0
18	50	44,4	52,0	62,3	71,7	85,3	97,2	113,4	125,0
20	50	49,3	57,8	69,2	79,6	94,8	108,0	126,0	138,0
25	50	61,9	72,6	86,9	100,0	119,0	136,0	158,0	174,0
30	50	73,8	86,6	104,0	119,0	142,0	162,0	189,0	207,0

Contact our Helpline for
any special requirements:
Tel: +44 (0) 151 424 6821
Fax: +44 (0) 151 495 1043
e-mail: sales@delavan.co.uk
Web: www.delavan.co.uk

