



Maximum Recommended Pressure:
70 Bar.G. (Metal) 7 Bar.G. (Plastic).

SPRAY CHARACTERISTICS

- Produces a uniform flat, fan shaped pattern with tapering edges.
- Requires overlapping for even distribution.

CONSTRUCTION AND MATERIALS

Four part design is available in the following materials:

- Nozzle cap - Brass and Stainless Steel.
- Nozzle strainers - Brass and Stainless Steel.
- Nozzle body - Brass and Stainless Steel.
- Nozzle tip - Brass and Stainless Steel.
- Other materials available to special order.
- Thread sizes are Male BSPT and Female BSPP.

ORDER EXAMPLE

LF 1.5-80° Brass = Tip Only.

1/4" LFM (Male) 1.5-80° Brass = Complete Assembly.

DIMENSIONS AND WEIGHTS

| Thread Size | Assembly Type | Dimensions (mm) | | | Weight (g) |
|-------------|---------------|-----------------|------|-------|------------|
| | | A Hex | B | C Hex | |
| 1/8 | LFF | 20,8 | 43,0 | 18 | 65 |
| 1/8 | LFM | 20,8 | 41,3 | 18 | 55 |
| 1/4 | LFF | 20,8 | 43,0 | 18 | 64 |
| 1/4 | LFM | 20,8 | 43,0 | 18 | 57 |
| 3/8 | LFF | 20,8 | 43,0 | 20,8 | 65 |
| 3/8 | LFM | 20,8 | 43,0 | 18 | 59 |

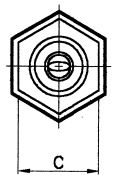
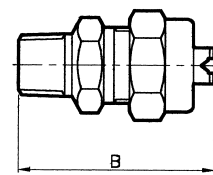

LFM (MALE) ASSEMBLY

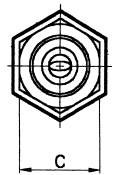
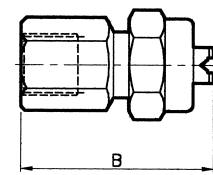

LFF (FEMALE) ASSEMBLY

CAPACITY CHART

| NOZZLE NUMBER | Max Mesh Size | Equiv Orifice Dia (mm) | FLOW RATE IN LITRES/MIN AT Bar.G. | | | | | | | | | | | SPRAY ANGLES (°) @ 2.8 Bar.G. | | | | | | | | |
|---------------|---------------|------------------------|-----------------------------------|------|------|------|------|------|------|------|------|------|---|-------------------------------|----|----|----|----|----|----|-----|--|
| | | | 0,7 | 1,0 | 2 | 3 | 4 | 5 | 7 | 10 | 20 | 35 | 0 | 15 | 25 | 40 | 50 | 65 | 80 | 90 | 110 | |
| LF 0,4 | 200 | 0,41 | 0,08 | 0,09 | 0,13 | 0,16 | 0,18 | 0,20 | 0,24 | 0,29 | 0,41 | 0,54 | * | * | * | | | | | | | |
| LF 0,5 | 200 | 0,46 | 0,10 | 0,11 | 0,16 | 0,20 | 0,23 | 0,25 | 0,30 | 0,36 | 0,51 | 0,67 | * | * | * | | | | | | | |
| LF 0,67 | 100 | 0,53 | 0,13 | 0,16 | 0,22 | 0,27 | 0,31 | 0,35 | 0,41 | 0,49 | 0,69 | 0,91 | * | * | * | | | | | | | |
| LF 1,0 | 100 | 0,66 | 0,19 | 0,23 | 0,32 | 0,39 | 0,45 | 0,51 | 0,60 | 0,72 | 1,0 | 1,3 | | | | | | | | | | |
| LF 1,5 | 100 | 0,76 | 0,29 | 0,34 | 0,48 | 0,59 | 0,68 | 0,76 | 0,9 | 1,1 | 1,6 | 2,1 | | | | | | | | | | |
| LF 2,0 | 50 | 0,9 | 0,38 | 0,46 | 0,64 | 0,78 | 0,9 | 1,0 | 1,2 | 1,4 | 2,0 | 2,6 | | | | | | | | | | |
| LF 3,0 | 50 | 1,10 | 0,57 | 0,68 | 0,97 | 1,2 | 1,4 | 1,5 | 1,8 | 2,2 | 3,1 | 4,1 | | | | | | | | | | |
| LF 4,0 | 50 | 1,25 | 0,76 | 0,91 | 1,3 | 1,6 | 1,8 | 2,0 | 2,4 | 2,9 | 4,1 | 5,4 | | | | | | | | | | |
| LF 5,0 | 50 | 1,4 | 0,95 | 1,1 | 1,6 | 2,0 | 2,3 | 2,5 | 3,0 | 3,6 | 5,1 | 6,7 | | | | | | | | | | |
| LF 6,0 | 50 | 1,5 | 1,1 | 1,4 | 1,9 | 2,3 | 2,7 | 3,1 | 3,7 | 4,3 | 6,1 | 8,1 | | | | | | | | | | |
| LF 8,0 | 50 | 1,75 | 1,5 | 1,8 | 2,6 | 3,2 | 3,7 | 4,1 | 4,9 | 5,8 | 8,2 | 10,8 | | | | | | | | | | |
| LF 10 | 50 | 2,0 | 1,9 | 2,3 | 3,2 | 3,9 | 4,5 | 5,1 | 6,0 | 7,2 | 10,2 | 13,5 | | | | | | | | | | |
| LF 15 | | 2,4 | 2,9 | 3,4 | 4,8 | 5,9 | 6,8 | 7,6 | 9,0 | 10,8 | 15,3 | 20,2 | | | | | | | | | | |
| LF 20 | | 2,8 | 3,8 | 4,6 | 6,4 | 7,8 | 9,0 | 10,2 | 12,1 | 14,4 | 20,4 | 27,0 | | | | | | | | | | |
| LF 25 | | 3,1 | 4,8 | 5,7 | 8,1 | 9,9 | 11,4 | 12,7 | 15,0 | 18,0 | 25,5 | 33,7 | | | | | | | | | | |
| LF 30 | | 3,6 | 5,7 | 6,8 | 9,7 | 11,9 | 13,7 | 15,3 | 18,1 | 21,6 | 30,5 | 40,3 | | | | | | | | | | |
| LF 40 | | 4,0 | 7,6 | 9,1 | 12,9 | 15,8 | 18,2 | 20,4 | 24,1 | 28,8 | 40,7 | 53,9 | | | | | | | | | | |
| LF 50 | | 4,4 | 9,5 | 11,4 | 16,1 | 19,7 | 22,7 | 25,4 | 30,0 | 35,9 | 50,8 | 67,2 | | | | | | | | | | |

* Brass Only

Contact our Helpline for any special requirements:
Tel: +44 (0) 151 424 6821
Fax: +44 (0) 151 495 1043
e-mail: sales@delavan.co.uk
Web: www.delavan.co.uk

