

SPRAY CHARACTERISTICS

- Produces a uniform, flat spray without hard edges.
- Tapered edges of pattern allow overlapping for even distribution.
- Impact of spray is generally greater with narrower spray angles assuming equal flow rates.
- Orifice is offset 5° to axis of dovetail.

CONSTRUCTION AND MATERIALS

- Dovetail connection nozzle/body for positive alignment.
- 3 piece design with male thread or Welding Nipple body, available in:
 - Brass.
 - Stainless Steel.
 - Mild Steel (Welding Nipple body only).
- Longer Welding Nipple bodies available to special order.
- Thread sizes are Male BSPT and Female BSPP.
- Other materials available to special order.

ORDER EXAMPLE

LD 15-65° Stainless Steel = Tip Only.

1/4" LDM (Male) 6-65° Stainless Steel = Complete Assembly.

LDW 6-65° Stainless Steel = Welding Assembly.

DIMENSIONS AND WEIGHTS

Thread Size	Assembly Type	Dimensions (mm)			Weight (g)
		A Hex	B Hex	C	
1/8	LDF	18,0	20,8	43,0	65
1/8	LDM	18,0	20,8	41,3	55
1/4	LDF	18,0	20,8	43,0	64
1/4	LDM	18,0	20,8	43,0	57
3/8	LDF	20,8	20,8	43,0	65
3/8	LDM	18,0	20,8	43,0	59
-	LDW	17,5 dia.	20,8	29,2	46

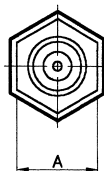
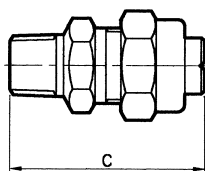
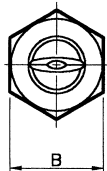

LDM (MALE) ASSEMBLY

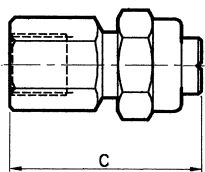
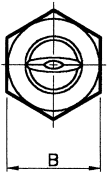

LDF (FEMALE) ASSEMBLY

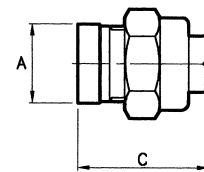

LDW WELDING ASSEMBLY

Maximum Recommended Pressure: 100 Bar.G.

CAPACITY CHART

NOZZLE NUMBER	Equiv Orifice Dia. (mm)	FLOW RATE IN LITRES/MIN AT Bar.G.									SPRAY ANGLES (°) @ 2.8 Bar.G.									
		0,7	1,0	2,0	3,0	5	7	10	15	20	0	15	25	40	50	65	80	90	100	110
LD 1	0,66	0,19	0,23	0,32	0,39	0,51	0,60	0,72	0,88	1,02	*	*	*	*	*	*	*	*	*	
LD 2	0,9	0,38	0,45	0,63	0,80	1,02	1,24	1,47	1,77	1,51					*	*	*	*	*	
LD 3	1,1	0,60	0,67	0,98	1,18	1,53	1,79	2,14	2,65	2,04						*	*	*	*	
LD 4	1,25	0,78	0,94	1,30	1,56	2,08	2,43	2,86	3,54	4,11									*	*
LD 5	1,4	0,96	1,16	1,61	1,99	2,54	3,02	3,62	4,41	5,10										*
LD 6	1,5	1,14	1,39	1,92	2,37	3,05	3,62	4,34	5,29	6,12										*
LD 8	1,75	1,51	1,88	2,55	3,17	4,12	4,81	5,72	7,06	8,13										*
LD 10	2,0	1,92	2,28	3,22	3,93	5,10	6,05	7,24	8,84	10,20										*
LD 15	2,4	2,84	3,44	4,92	6,16	7,90	9,20	10,70	13,20	15,20										*
LD 20	2,8	3,80	4,47	6,26	8,05	10,20	12,40	14,70	17,70	20,40										*
LD 25	3,1	4,60	5,80	8,00	9,94	13,00	15,10	18,30	22,30	25,50										*
LD 40	4,0	7,80	9,40	13,00	15,62	20,80	24,30	28,60	35,40	41,10										*
LD 50	4,4	9,60	11,60	16,10	19,89	25,40	30,20	36,20	44,10	51,00										*

* Brass Only

FLAT SPRAY

TYPE LD

Contact our Helpline for any special requirements:
Tel: +44 (0) 151 424 6821
Fax: +44 (0) 151 495 1043
e-mail: sales@delavan.co.uk
Web: www.delavan.co.uk

